

OPERATOR'S MANUAL

65940-X

INCLUDING: OPERATION, INSTALLATION AND MAINTENANCE.

INCLUDE MANUALS: Air Line Safety Information (pn 100400-76).

RELEASED: 9-15-77

REVISED: 2-8-10

(REV. K)

65940-X Air Manifold Assembly



**READ THIS MANUAL CAREFULLY BEFORE INSTALLING,
OPERATING OR SERVICING THIS EQUIPMENT.**

It is the responsibility of the employer to place this information in the hands of the operator. Keep for future reference.

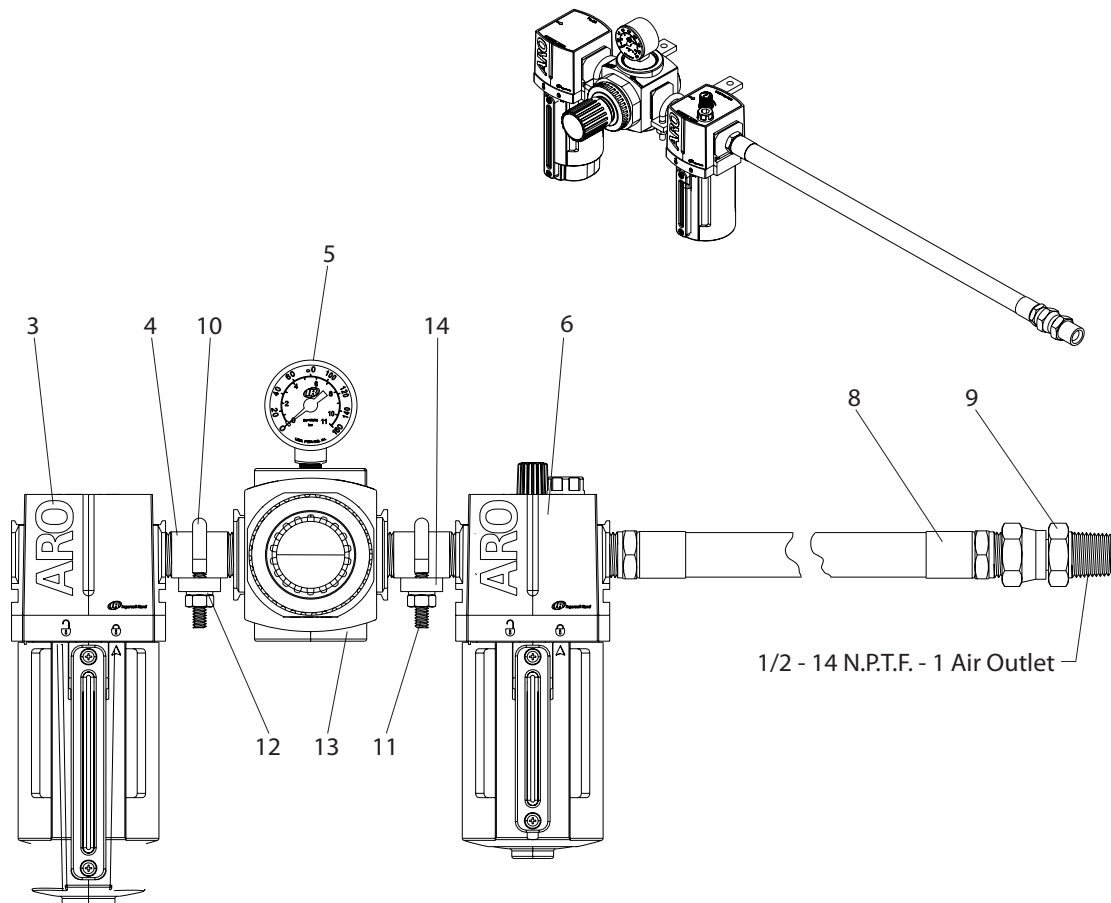

Figure 1

PARTS LIST

Item	Description (size)	(Qty)	Part No.	Item	Description (size)	(Qty)	Part No.
3	Filter	(1)	F35341-420	9	Swivel	(1)	75366
4	Nipple (1/2 - 14 N.P.T. x 2")	(2)	Y44-31-C	10	"U" Bolt (1/4" - 20)	(2)	71796
5	Gauge	(1)	29725	11	Nut (1/4" - 20)	(4)	Y12-4-C
6	Lubricator	(1)	L36341-100	12	Lock Washer (1/4")	(8)	Y14-416
8	Hose (1/2 - 14 N.P.T.F. x 1/2" i.d.)			13	Air Regulator	(1)	R37341-100
	models 65940 (1-1/2 feet long)	(1)	621501-1-F	14	Mounting Plate	(2)	90935
	models 65940-1 (2 feet long)	(1)	621501-2	15	Cap Screw (1/4" - 20 x 5/8") (see figure 3)	(4)	Y6-42-C

INGERSOLL RAND COMPANY LTD
209 NORTH MAIN STREET - BRYAN, OHIO 43506
(800) 495-0276 • FAX (800) 892-6276
www.ingersollrandproducts.com

© 2010

CCN 81376956

ARO  **Ingersoll Rand**
Industrial Technologies

INSTALLATION

1. Position the two (14) mounting plates on the two post lift mounting arm (see figures 2 and 3).
2. Using four (15) cap screws and four (12) lock washers, fasten the mounting plates to the four holes located on the top of the mounting arm.
3. Place the air manifold assembly on the mounting plates and

secure using two (10) "U" bolts, four (12) lock washers and four (11) nuts (see figures 1 and 2).

NOTE: The regulator is rotated upward 90° for easier viewing of (5) gauge.

4. Connect the (8) hose and (9) swivel to the pump air motor inlet.
5. Connect 1/2" i.d. air line hose to (3) filter.

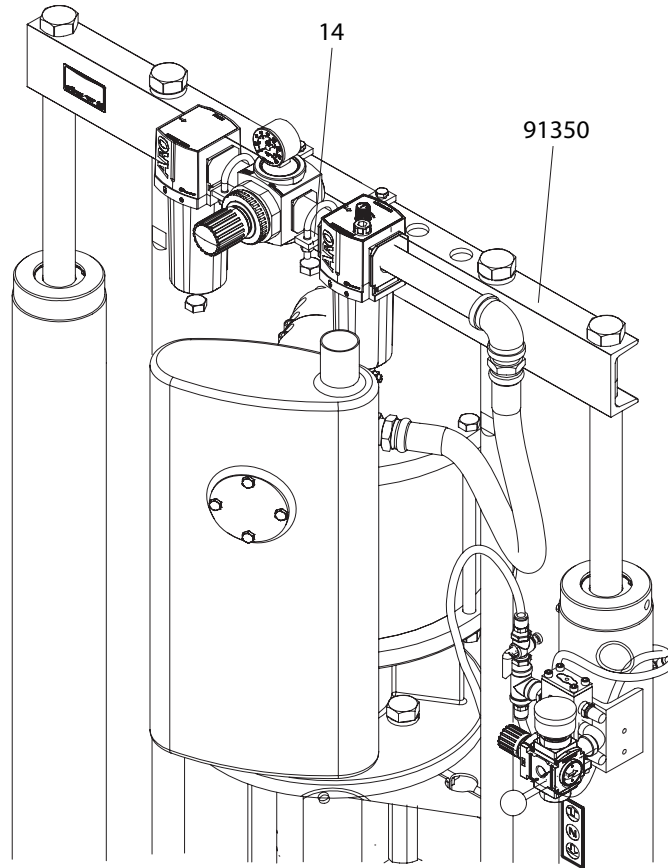

Figure 2

Mounting plate and parts included with assembly (1 mounting bracket shown).

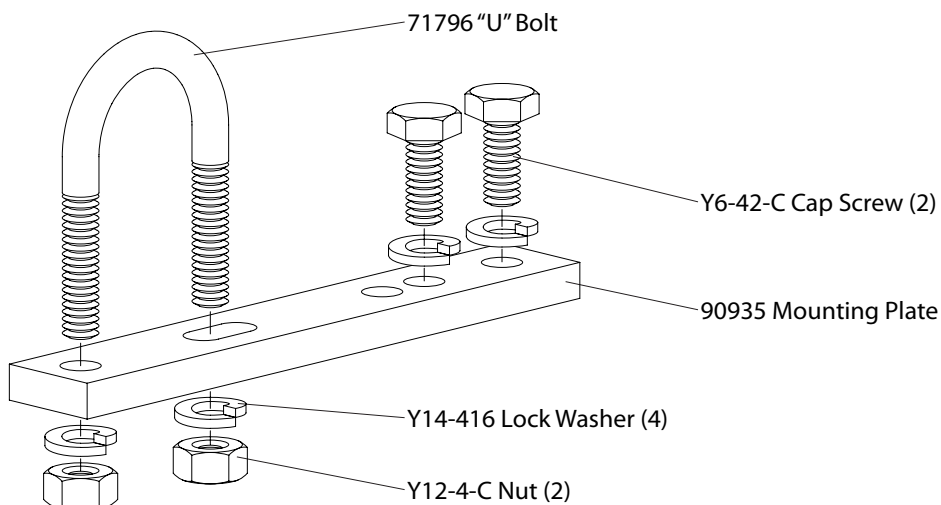

Figure 3